



WELDING MACHINE & ACCESSORIES



HAND WELDING MACHINES

MICROTEC: HAND WELDING MACHINE

MT 1500 S



Technical data	Microtec 1500 S
Input voltage	230 V, 50 - 60 Hz
Charging voltage	600 VA
Control system	SCR pulse system
Cycle time	0,2 - 0,4 sec.
Power output	700 W
Output voltage	0 - 9 V
Output current	0 - 1100 A
Dimensions WxDxH	165 x 450 x 405 mm
Weight	28 kg

Standard equipment

- Control unit, mains cable, foot switch cable for electrode holder (1300 mm), ground cable (1300 mm) with copper ground plate (2 x 20 x 100 mm)
- Electrode holder, black Ø 2, 3, 4 and 5 mm (1 off each)
- Electrode holder, brown Ø 3, 4 mm (1 off each)
- Magnetic electrodes Ø 2 x 50 mm, Ø 3 x 50 mm, Ø 4 x 50 mm, Ø 4 x 60 mm (1 off each)
- Standard electrodes Ø 2 x 50 mm, Ø 3 x 50 mm, Ø 4 x 50 mm (1 off each)
- Standard flat electrodes 1,2 x 5 x 35 mm
- Adapter for clamping of flat electrodes
- Tool cabinet
- Sheet metal shears
- 1 pair of protective gloves
- 1 off protective glasses
- 1 off adhesive tape
- 1 off spare fuse
- Welding powder (50 g each):
MP 66/ N 51 (approx. 63 HRC)
MP 70/ N 80 (approx. 38 - 40 HRC)
- Sheet metal strips (10 off each):
NAK 80 - 0,1 x 5 x 100 mm, approx 38-40 HRC
NTA 1 - 0,1 x 30 x 70 mm, approx.135 HV
NTA 2 - 0.2 x 30 x 70 mm, approx.135 HV

REF

MT1500S

MICROTEC: HAND WELDING MACHINE

MT 2500



Technical data	Microtec 2500 Standard function	Microtec 2500 Precision function
Input voltage	230 V, 50 - 60 Hz	230 V, 50 - 60 Hz
Charging voltage	1000 VA	400 VA
Control system	SCR pulse system	SCR pulse system
Cycle time	0,2 - 0,4 sec.	0,2 - 0,4 sec.
Power output	1000 W	400 W
Output voltage	0 - 10 V	0 - 6 V
Dimensions WxDxH	375 x 520 x 270 mm	375 x 520 x 270 mm
Weight	35 kg	35 kg

Standard equipment

- Control unit, mains cable, foot switch cable for electrode holder (1300 mm), ground cable (1300 mm) with copper ground plate (2 x 20 x 100 mm)
- Electrode holder black Ø 2, 3 and 4 mm (1 off each) Ø 5 mm (2 off)
- Electrode holder, brown Ø 3 mm (2 off) Ø 4 mm (1 off)
- Magnetic electrodes Ø 2 x 50 mm, Ø 3 x 50 mm, Ø 4 x 50 mm, Ø 4 x 60 mm (1 off each)
- Standard electrodes Ø 2 x 50 mm, Ø 3 x 50 mm, Ø 4 x 50 mm, Ø 5 x 60 mm (1 off each)
- Standard flat electrodes 1,2 x 5 x 35 mm
- Adapter for clamping of flat electrodes
- Tool cabinet
- Sheet metal shears
- 1 pair of protective clove
- 1 off protective glasses
- 1 off adhesive tape
- 1 off spare fuse
- Welding powder (50 g each):
MP 66/N 51 (approx. 63 HRC)
MP 70/N 80 (approx. 38-40 HRC)
- Sheet metal strips (10 off each):
NAK 80 - 0,1 x 5 x 100 mm, approx. 38-40 HRC
NTA 1 - 0,1 x 30 x 70 mm, approx. 135 HV
NTA 2 - 0.2 x 30 x 70 mm, approx. 135 HV

REF

MT2500



MAGNETIC ELECTRODES FOR POWDER **EM**

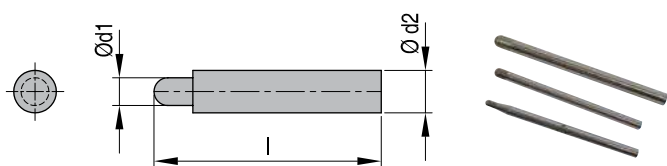

REF	d1	d2	l
EMR2	2	3	50
EMR3	3	3	50
EMR4	4	4	60
EMR5	5	5	60

MAGNETIC ELECTRODES FOR POWDER **EM**

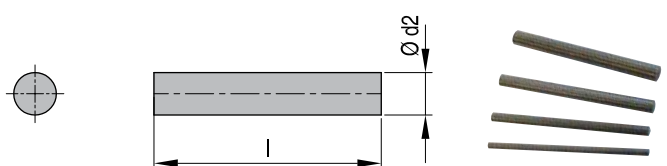

REF	d2	l
EM210	2	50
EM211	3	50
EM212	4	50
EM213	5	50

MAGNETIC ELECTRODES FOR POWDER **EM**

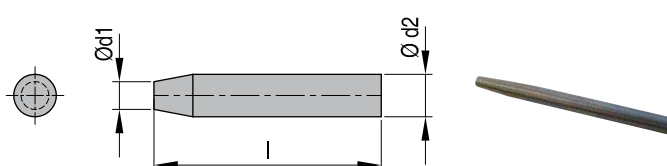

REF	d1	d2	l
EMT4	1,5	4	50
EMT5	2,5	5	50

STANDARD ELECTRODES **E**

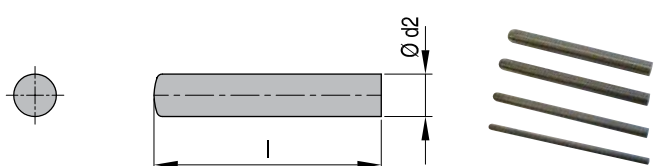

REF	d2	l
ER22	2	50
ER33	3	50
ER44	4	50
ER55	5	50

STANDARD ELECTRODES **E**

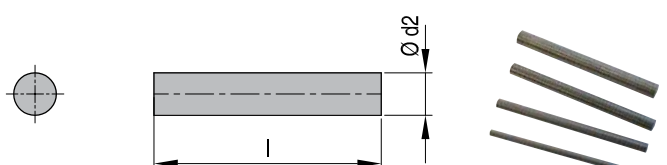

REF	d2	l
E201	2	50
E202	3	50
E203	4	50
E204	5	50

HAND WELDING MACHINES

STANDARD ELECTRODES

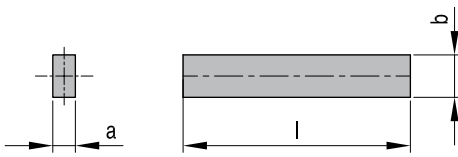
E

REF	a	b	l
E205	1,2	5	35
E206	2,2	5	35

STANDARD ELECTRODES

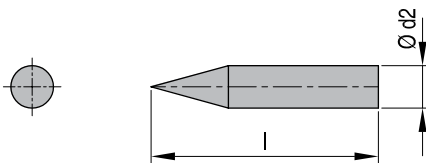
E

REF	d1	d2	l
ESP2	-	2	45

STANDARD ELECTRODES

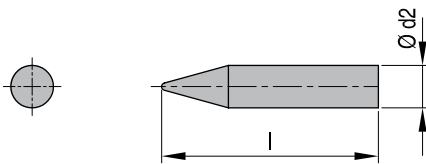
E

REF	d1	d2	l
ESR2	-	2	45

ELECTRODE HOLDER / ADAPTER

H / A



REF	Suitable for electrodes	ø	REF	Suitable for electrodes
H302	EMR2, EMR3, EM211, ER33,E202	15 mm	A403001	E205 (Rectangle electrode)
H303	EMR4, EM212, EMT4, ER44, E203	15 mm	A404	E206 (Rectangle electrode)
H304	EMR5, EM213, EMT5, ER55, E204	15 mm		
E306	EM210, ER22, E201E, ESP2, ESR2	12 mm		
E307	EMR2, EMR3, EM211, ER33,E202	12 mm		

WELDING MATERIAL - WIRE MTD ...

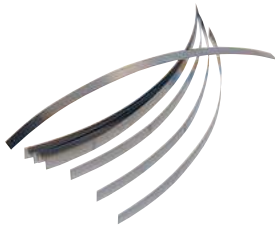

REF	Designation	Ø	Hardness	for steel types
MTD1	S 2	0,2	90 HRB	All mouldsteels
MTD2	S 3	0,3	90 HRB	
MTD3	S4	0,4	90 HRB	
MTD4	S5	0,5	90 HRB	

WELDING MATERIAL - SHEET MTB ...



REF	Designation	Dim.	Hardness	for steel types
MTB1	NT 6	0,2 x 5 x 100 mm	30 HRC	All mouldsteels
MTB2	NTA 1	0,1 x 30 x 70 mm	135 HV	
MTB3	NTA 2	0,2 x 30 x 70 mm	135 HV	
MTB4	NS 1	0,1 x 30 x 70 mm	90 HRB	
MTB5	NS 2	0,2 x 30 x 70 mm	90 HRB	preheat-treated steel
MTB6	NAK 80	0,1 x 5 x 100 mm	38-40 HRC	
MTB7	NAK 80	0,2 x 5 x 100 mm	38-40 HRC	1.2311
MTB8	HPM 2	0,1 x 5 x 100 mm	30-35 HRC	
MTB9	HPM 2	0,2 x 5 x 100 mm	30-35 HRC	preheat-treated steel
MTB10	NAK 55	0,1 x 5 x 100 mm	38-41 HRC	
MTB11	NAK 55	0,2 x 5 x 100 mm	38-41 HRC	All mouldsteels
MTB12		0,1 x 50 x 70 mm	45-48 HRC	
MTB13		0,2 x 50 x 70 mm	45-48 HRC	Stavax
MTB14		0,2 x 5 x 100 mm	40-42 HRC	

WELDING MATERIAL - POWDER MTP ...



REF	Designation	Hardness	for steel types
MTP1	N 90	16-20 HRC	All mouldsteels (esp. Ni alloys)
MTP2	N 51	63 HRC	1.3343, all mouldsteels
MTP3	N 11	50 HRC	Heat-treated steels
MTP4	N 61	51 HRC	1.2343, 1.2344
MTP5	N 70	50-55 HRC	All mouldsteels
MTP6	N 80	38-40 HRC	1. 2711
MTP7	N 55	34-41 HRC	Heat-treated steels
MTP8	N 39	50-52 HRC	Stavax
MTP9	SP 80	38-40 HRC	Preheat-treated steels
MTP10	SP 55	38-41 HRC	Preheat-treated steels
MTP11	N 5	54-56 HRC	1.2162, All mouldsteels
MTP12	N 6	38-45 HRC	1.2343, 1.2344
MTP13	N 14	30 HRC	1.2311, 1.2312
MTP14	N 15	30-35 HRC	1.2764
MTP15	N16	30-35 HRC	1.2767